



PEDERNALES ELECTRIC COOPERATIVE

POLE ATTACHMENT STANDARDS

Version 1.0

Issued Date: August 1, 2025

Effective Date: August 1, 2025



Management Approval and Document Control

Management Approval

Melody Horton

Manager, Joint Use

Date

Dawn Southwell

Director of Commercial, Industrial and Municipal Relations

Date

JP Urban

Chief Administrative Officer-Office of the EVP External Relations

Date

Document Control

PEC Pole Attachment Standards – Version 1.0

Document Title/Version

August 1, 2025

Date of Issue

August 1, 2025

Effective Date

REVISION HISTORY

Effective Date	Version Number	Individual Making Edits	Reason/Comments
			Initial Release



A. Attachment Clearance Requirements

E1: Clearance No Attachments

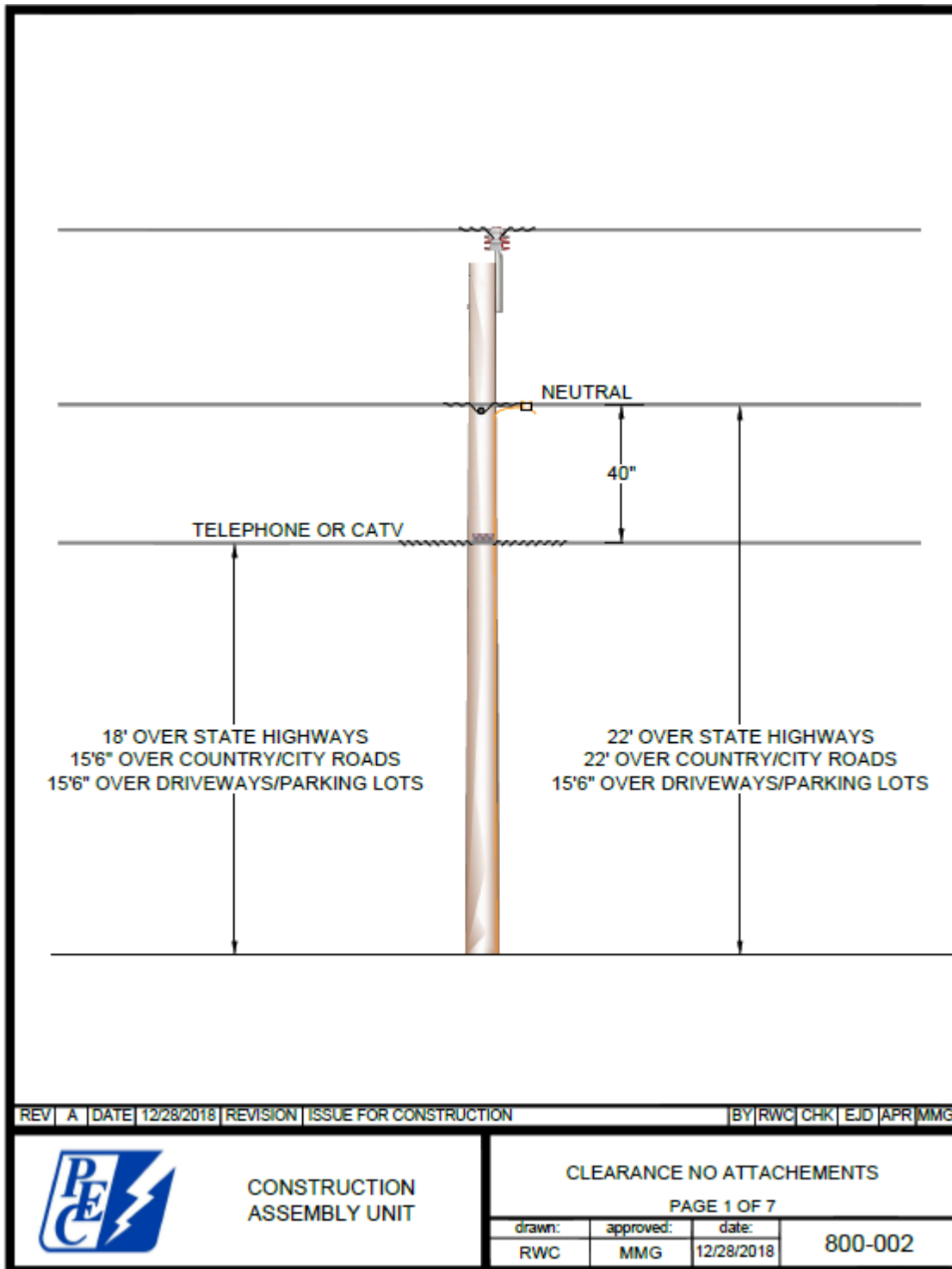



E2: Clearance Inline Transformer No Service

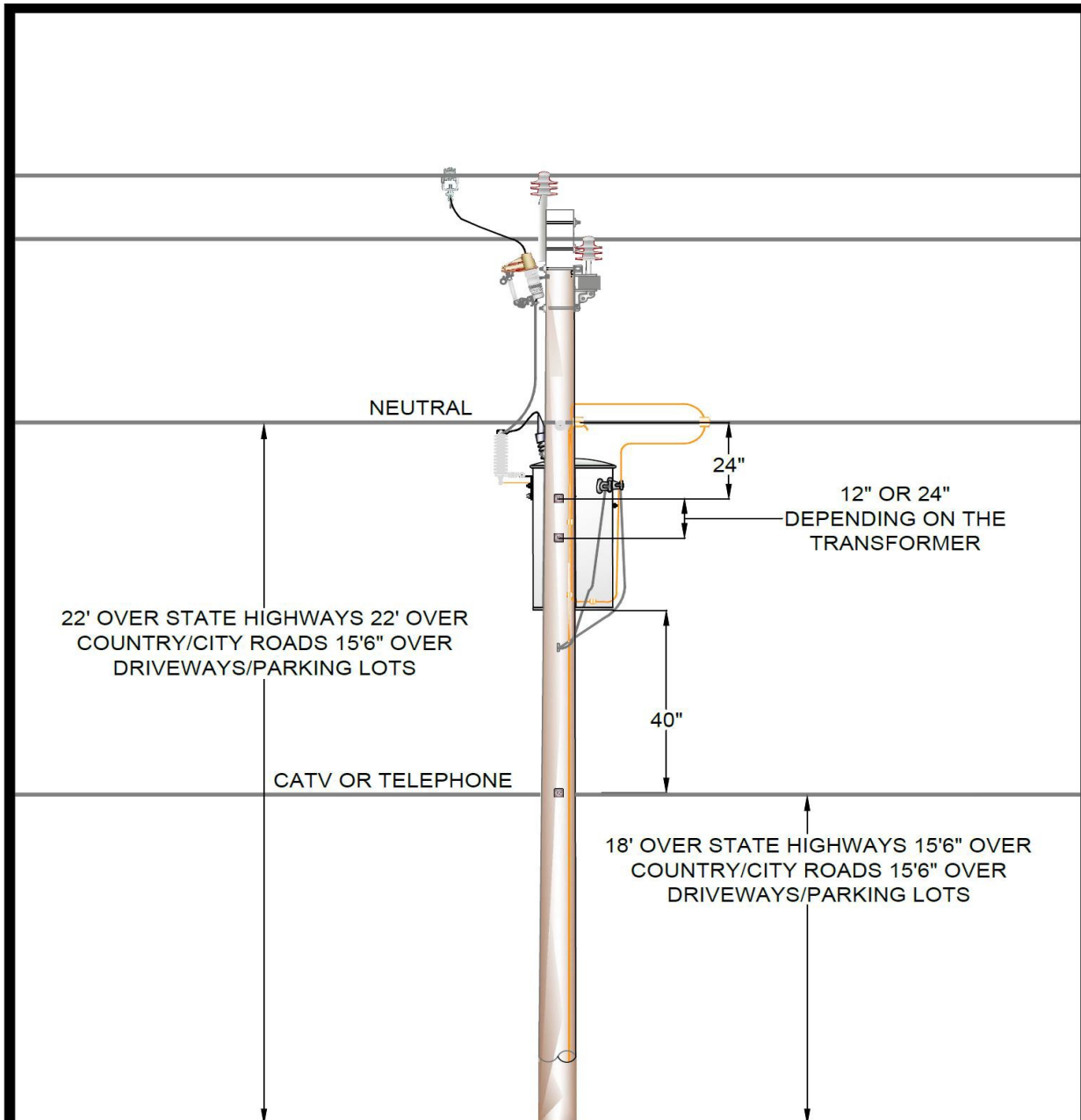

REV | A | DATE | 12/28/2018 | REVISION | ISSUE FOR CONSTRUCTION | BY | RWC | CHK | EJD | APR | MMG



CONSTRUCTION
ASSEMBLY UNIT

CLEARANCE INLINE TRANSFORMER
NO SERVICE
PAGE 2 OF 7

drawn:	approved:	date:
RWC	MMG	12/28/2018

800-003



E3: Clearance Dead End Transformer with Service

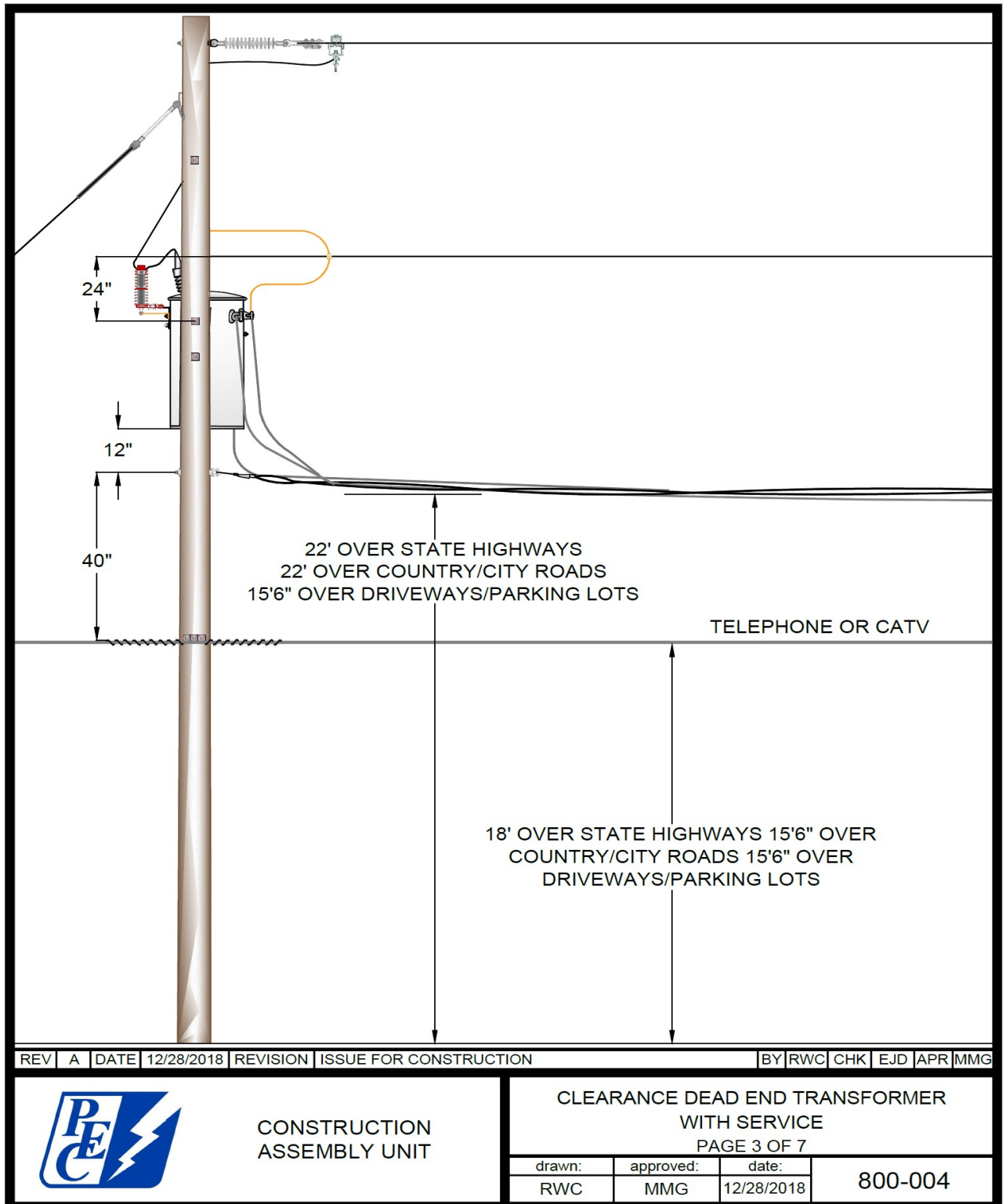



E4: Clearance on Recloser

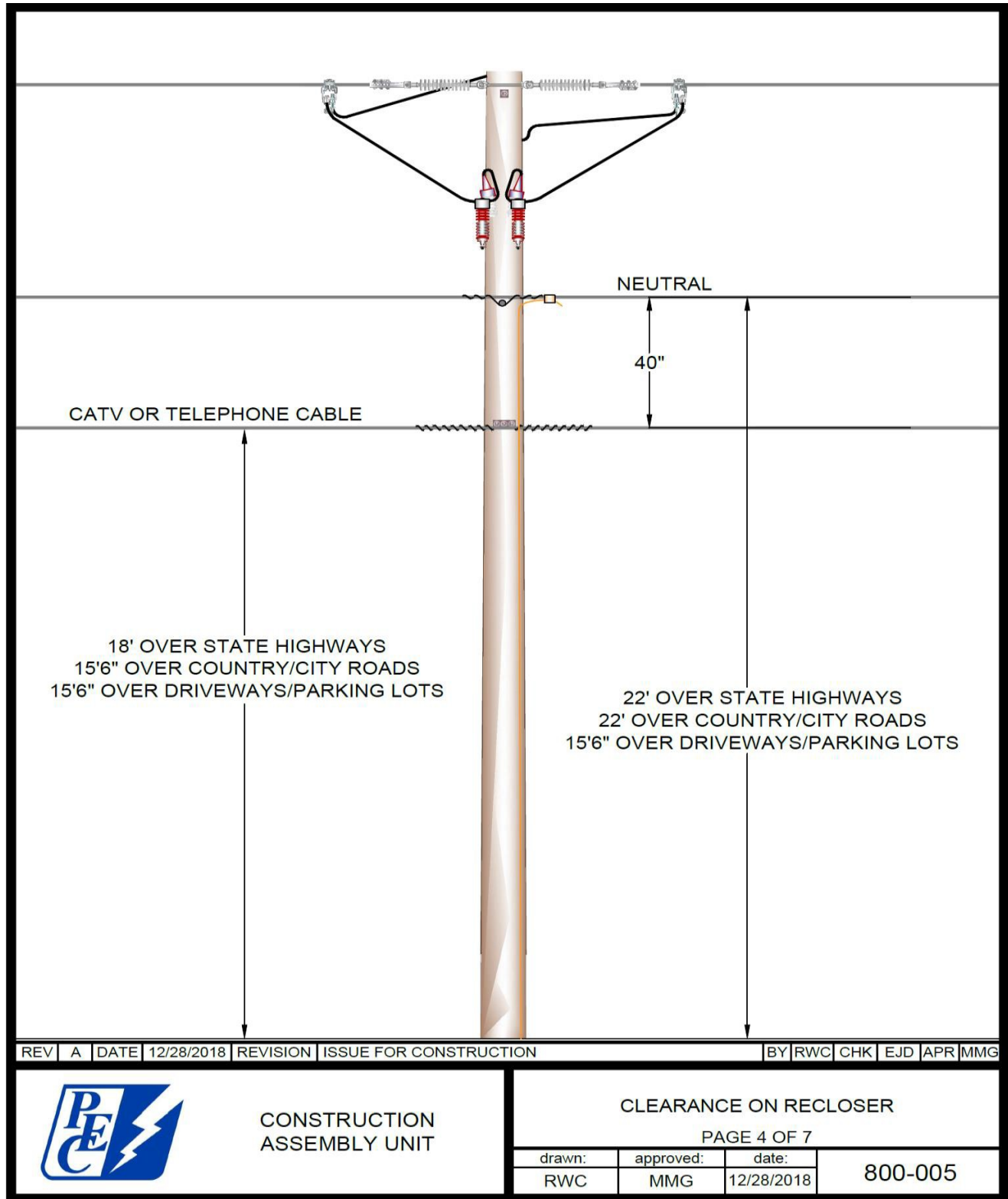



E5: Clearance Capacitor or Regulator

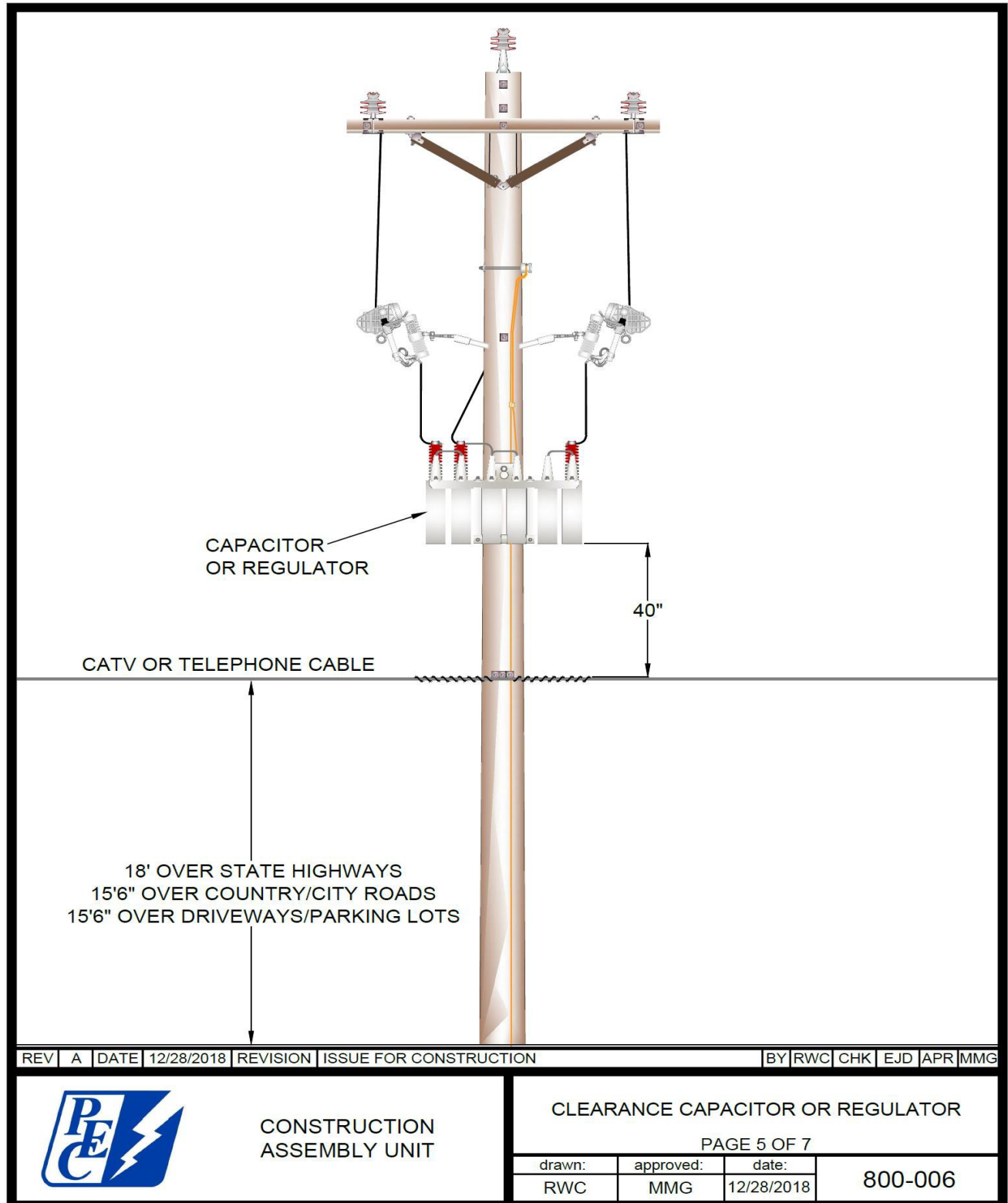



E6: Clearance between Electric and Communications on Different Supporting Structures

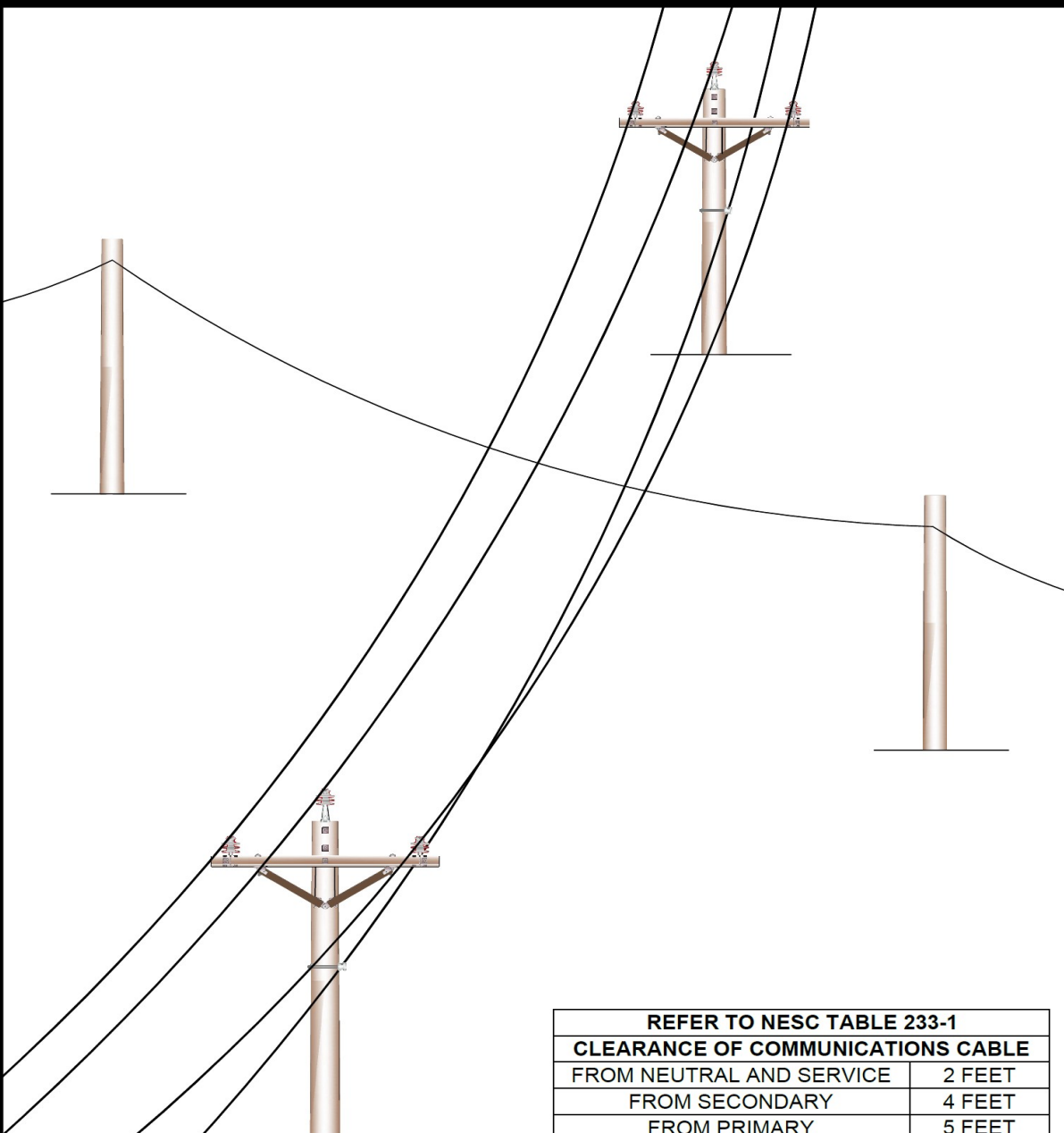



Diagram illustrating the clearance requirements between electric and communications cables on different supporting structures. The diagram shows three poles with various cable configurations and their respective clearances.

REFER TO NESC TABLE 233-1	
CLEARANCE OF COMMUNICATIONS CABLE	
FROM NEUTRAL AND SERVICE	2 FEET
FROM SECONDARY	4 FEET
FROM PRIMARY	5 FEET

REV | A | DATE | 12/28/2018 | REVISION | ISSUE FOR CONSTRUCTION | BY | RWC | CHK | EJD | APR | MMG



CONSTRUCTION
ASSEMBLY UNIT

CLEARANCE BETWEEN ELECTRIC AND
COMMUNICATIONS CABLE ON DIFFERENT
SUPPORTING STRUCTURES
PAGE 6 OF 7

drawn:	approved:	date:	800-007
RWC	MMG	12/28/2018	



E7: Communications on Riser

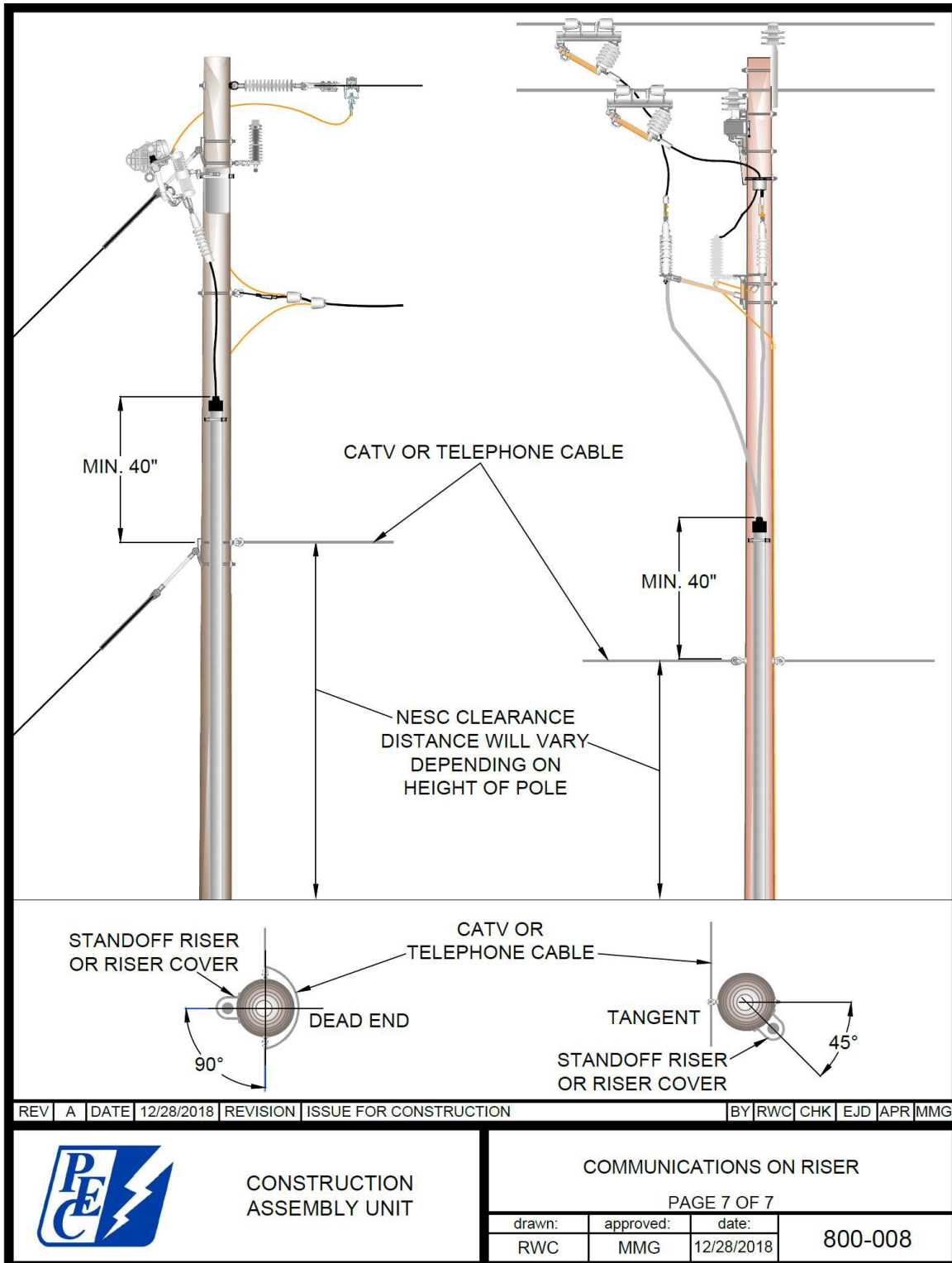

E8: Attachment Clearance Requirements

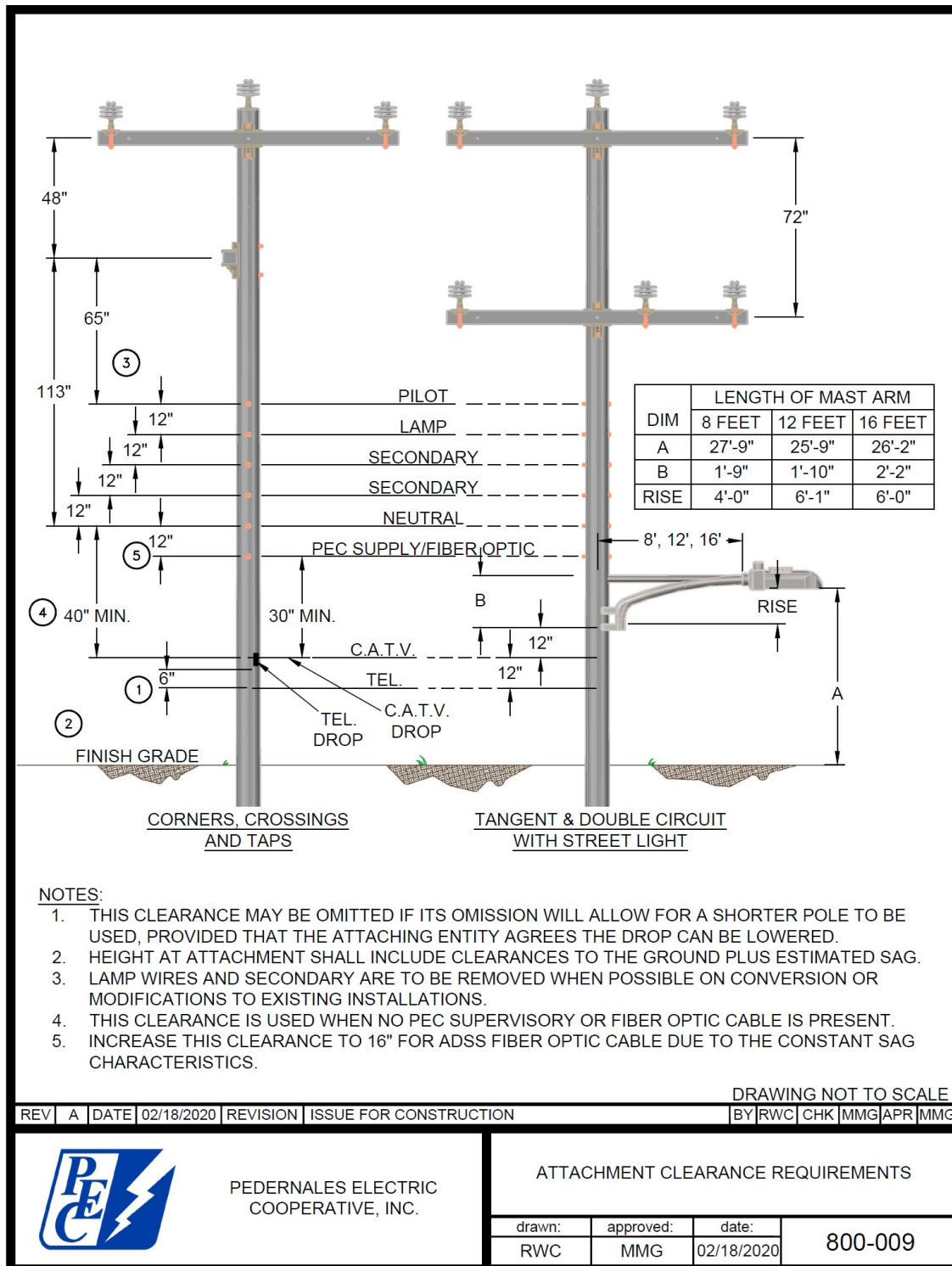



B. PEC Pole Attachment List & Tag Detail

11: Attachment Tagging Assignments as of December 22, 2020

1	PEC		36	CITY OF AUSTIN -GAATN FIBER
2	CHARTER SAN ANTONIO		37	CITY OF AUSTIN -CTM DEPT
3	AT&T		38	CITY OF BURNET-JOINT USE
4	GRANDE		39	CITY OF BURNET -POWER
5	MCI-VERIZON		40	CITY OF GEORGETOWN
6	HILL COUNTRY TELEPHONE COOP		41	CITY OF HORSESHOE BAY
7	HILL COUNTRY WIRELESS		42	CITY OF LAKEWAY
8	CHARTER AUSTIN		43	CITY OF SAN MARCOS
9	EMBARQ(SPRINT-CENTURY TEL)		44	
10	GVTC		45	
11	GVCS		46	
12	SUDDENLINK		47	GOOGLE
13	NORTHLAND CABLE		48	
14	CHARTER WACO		49	
15	SOUTHWEST TEXAS TELEPHONE		50	
16	WINDSTREAM		51	
17	FRONTIER		52	
18	WINDSTREAM		53	
19	CLARUS BROADBAND		54	
20	CONSOLIDATED COMMUNICATION		55	HILL COUNTRY RESORTS
21	GRANDE COMMUNICATION		56	MOLECULAR REBAR
22	LCRA		57	RIO BONITO RV
23	CPS		58	BERTRAM VFD
24	ONCOR ELECTRIC DELIVERY		59	BAY MARINE SPORTS CENTER
25			60	BERRY AVIATION
26	NEXSTREAM		61	DRIPPING SPRINGS ISD
27	RAPID COMMUNICATIONS		62	HAYS ISD
28	ECPI (WESTERN BROADBAND)		63	JOHNSON CITY ISD
29	ZAYO		64	LAKE TRAVIS ISD
30	FIBERLIGHT		65	LAGO VISTA ISD
31	LEVEL 3 COMMUNICATIONS		66	LEANDER ISD
32	AT&T WIRELESS		67	MARBLE FALLS ISD
33			68	ROUND ROCK ISD
34			69	TEXAS STATE UNIVERSITY
35			70	WIMBERLEY ISD (CNS)

12. Pole Attachment Tag Detail

For the purposes of Tagging an Attachment, Overlash or Wireless Installation (including a Mid-Span Installation), PEC requires the use of a Tag placed within twelve inches (12") of a Pole on the wires and cables, coded by number, color, or other means that will readily identify the owner of the Attachment at a Pole from ground level. The Tag shall be as specified below or consistent with accepted communication industry standards or other Attaching Entity supplied tag approved in writing by PEC, provided the Tag is made of materials which are weather, corrosion, and Ultraviolet (UV) resistant.

